



100%
TRACEABILITY
31 MILL
CERTIFICATE



NITESH AUTO ENGINEERING PVT.LTD.

Performance through precision



About Us – Since 1987

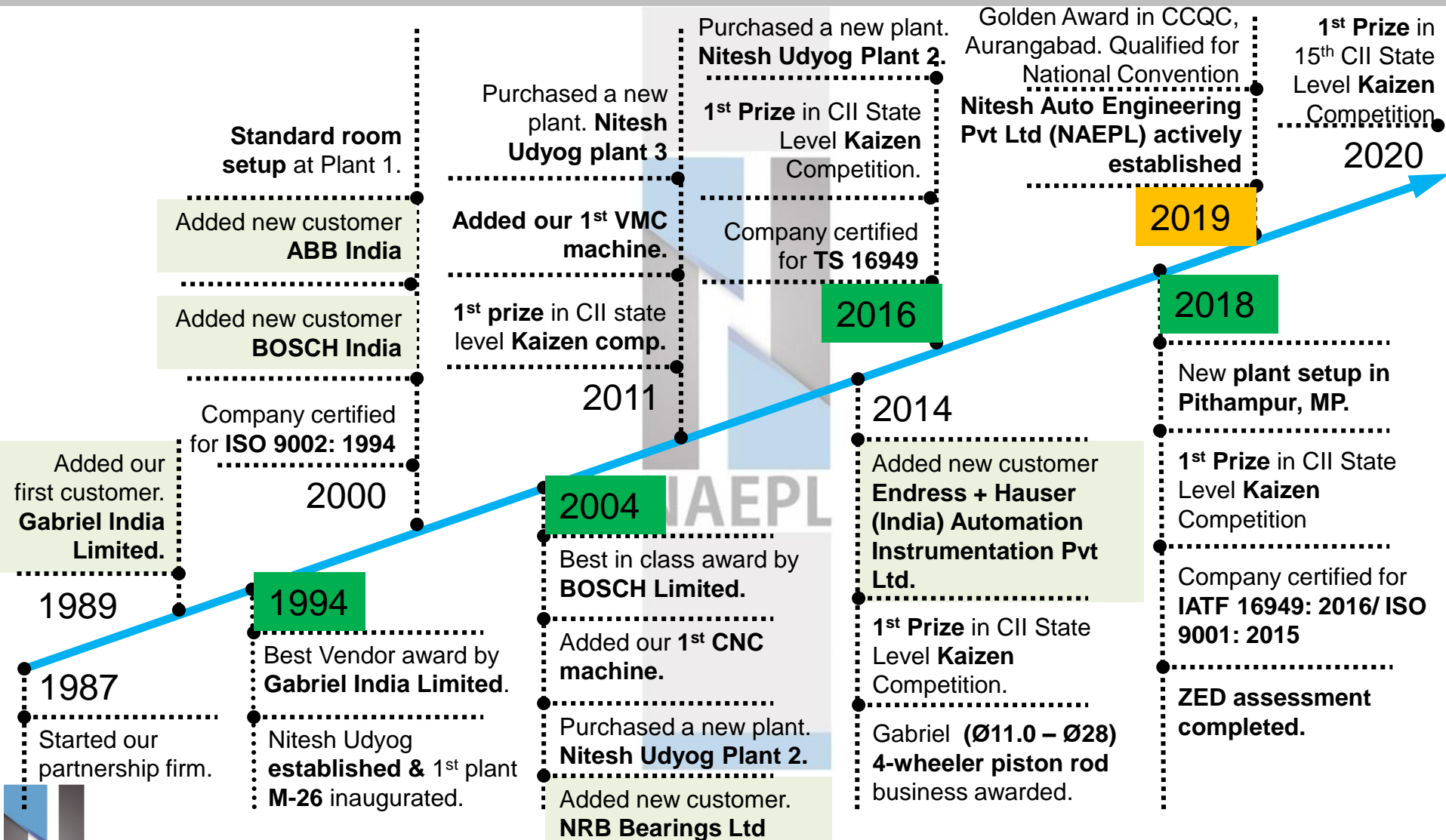

About Us

3 locations at
Nashik , MH &
1 location at
Pithampur, MP

Nashik locations are manufacturing units. Pithampur location is presently used for trading of MBC products.

Output
components.

1.2 - 1.5
million parts/
month

Main line of business is manufacturing of precision machined components and sub assemblies.

We work across
Varied sectors

- Automotive.
- Defense engineering.
- Aerospace.
- Pump manufacturers.
- Bearing manufacturers.
- Automation industry.

About Us

Core Purpose

We are committed to deliver/ provide high precision and world-class solutions to our stake holders.

Core Values

- **COMMITMENT** – Committed to our stake holders at every stage.
- **EMPOWERMENT** – Empowering our stake holders (Internal & External).
- **LEAN** – Lean approach (In all the processes we develop).
- **ENVIRONMENT** – Adapting and changing to environmentally sustainable processes/ methods/ technologies.
- **SAFETY** – Safety first.

Aspirational Core Value

- **O-T-I-F-B-E-Q** – **O**n **T**ime **I**n **F**ull **B**eyond **E**xpected **Q**uality.

Company Profile

Vision Statement



COMPANY VISION

“To provide performance through precision (To ensure first time right & always right)”.

Company Profile

Esteemed clients



Company Profile

Q (Quality), D (Delivery) Stats

Customer Quality Rating

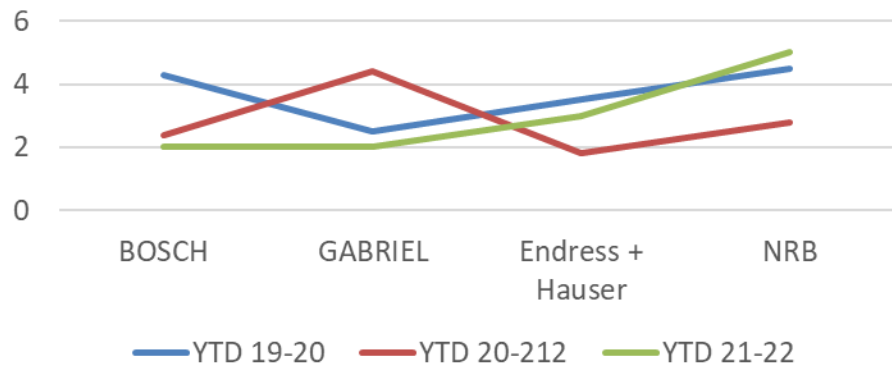

Internal PPM

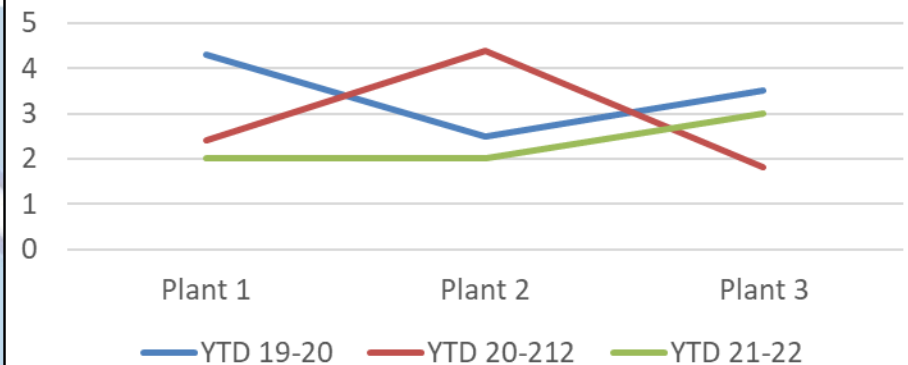

Customer Annual Audit data

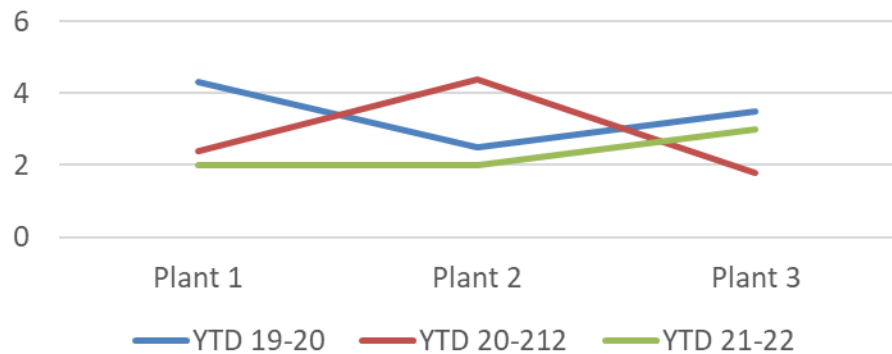

Delivery

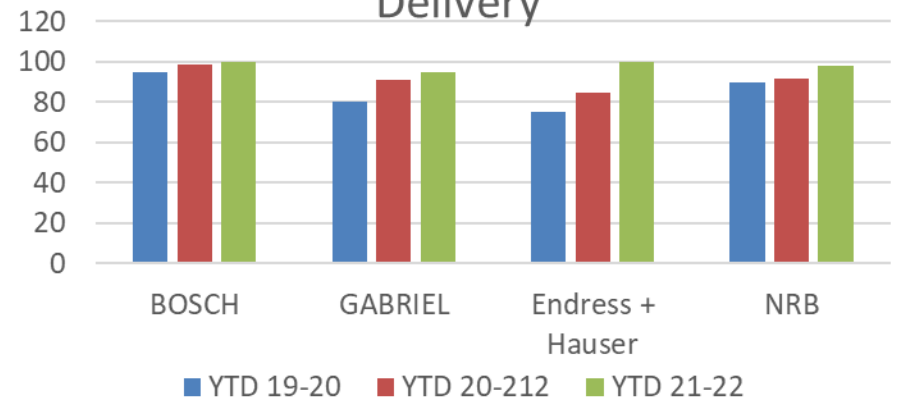

Company Profile

Turnover

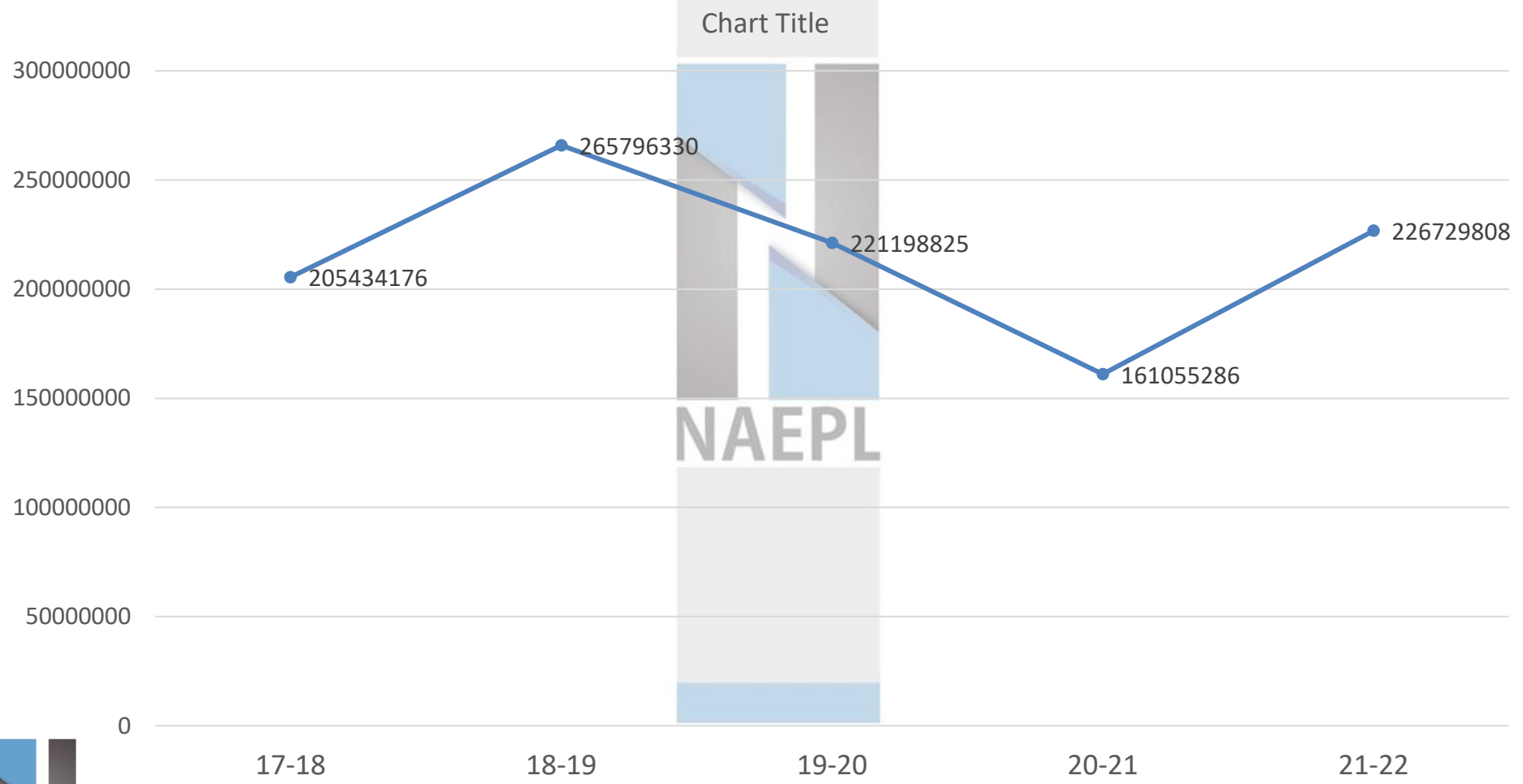

Company Profile

Business Interests

Automotive

Fuel Injection components

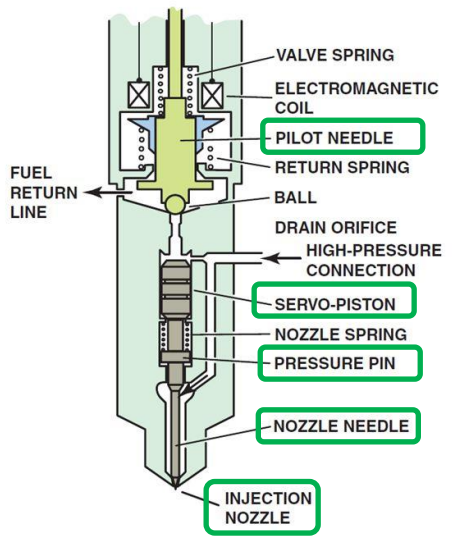

Nozzle Needle



Injector Body



Injection Nozzle



Distance Piece & other spares

Company Profile

Business Interests

Automotive

Automotive suspensions



Piston Rods



Base Valve



Special Nuts

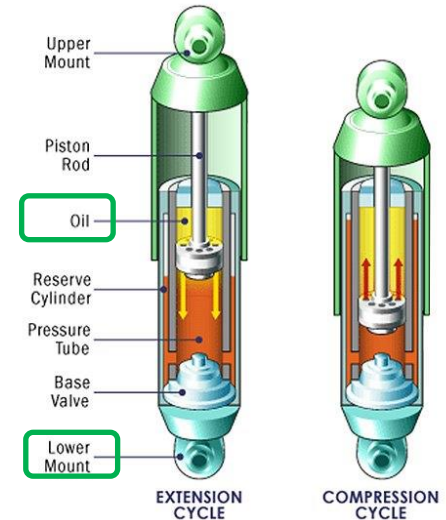
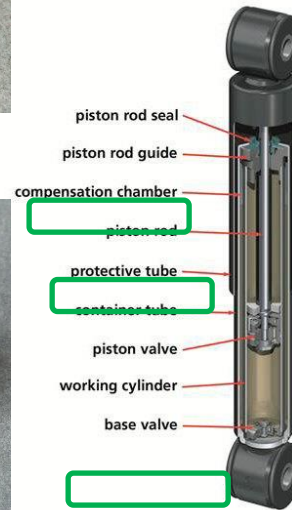

Supplying Piston Rods suitable for Cycles, 2WH, 3WH, 4WH, Heavy vehicles, Locomotives, Hydraulic & Pneumatic cylinders.

Company Profile

Business Interests

Automotive & Non-Automotive

Bearings

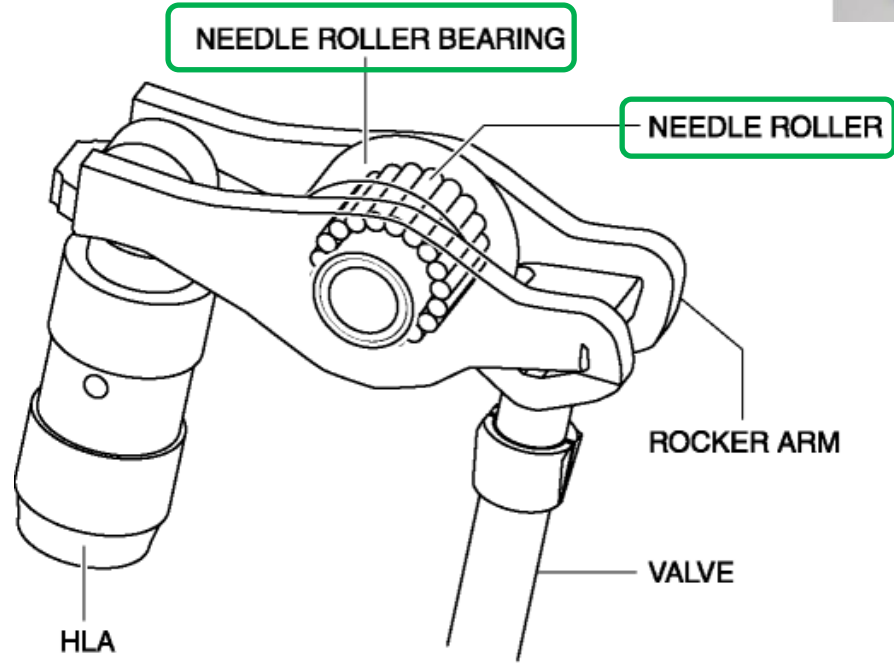

Needle Roller Bearing

Inner Race



Company Profile

Business Interests

Non – Automotive

Level & Pressure devices parts

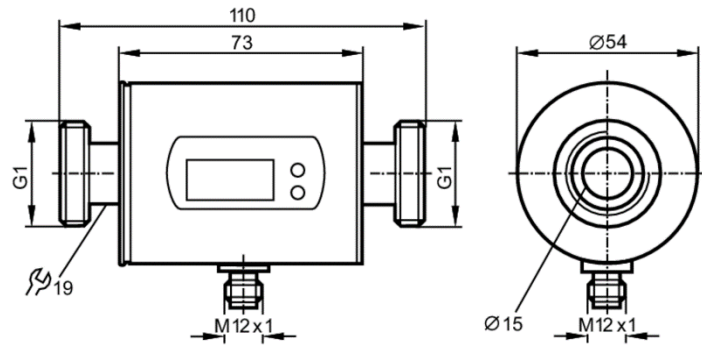

Adapter & Sensor Body

Company Profile

Business Interests

Non – Automotive

Conveyors spares



Bearing Race - Outer



Bearing Pin - Inner

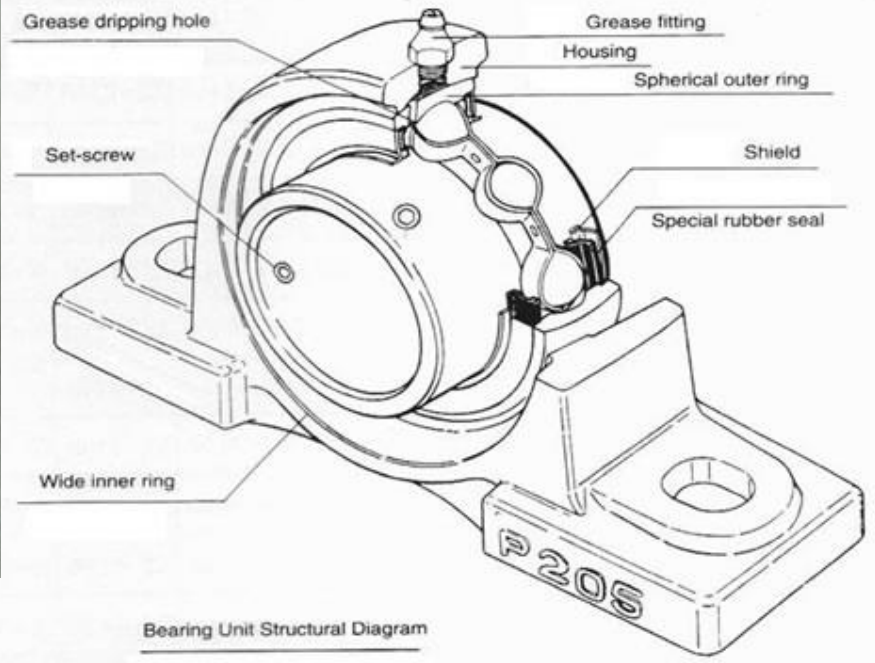

Bearing Unit Structural Diagram

Company Profile

Business Interests

Non – Automotive

Power Distribution parts

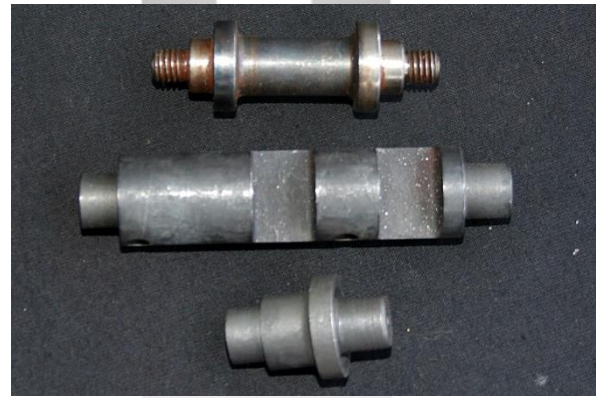

Power Distribution parts



Extension Pin



Cam Shaft

Company Profile

Business Interests – Customized Rotary Shafts

Customized Rotary Shaft



These general-purpose shafts with bearings, sprockets, and gears are used to transmit rotary motion. These can also be manufactured as per customer drawings supplied.

Ultra-Straight Tight-Tolerance Rotary Shafts

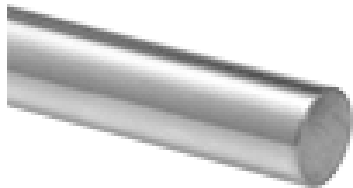

Eight times straighter than standard shafts, these tight-tolerance shafts minimize vibrations and reduce wear to bearings and other components. They also have diameter tolerances that are twice as tight as standard rotary shafts.

Keyed Rotary Shaft

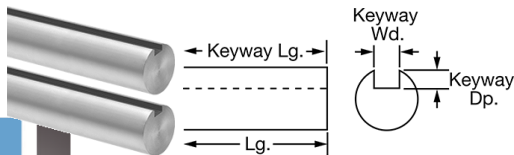

Combine with a machine key to transmit torque to gears, sprockets, and other power transmission components.

Company Profile

Business Interests

D-Profile Rotary Shafts

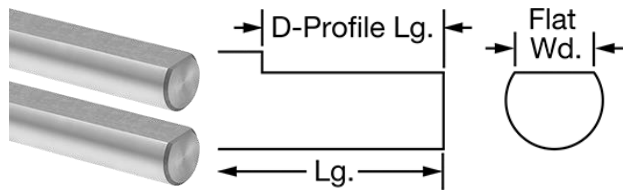

A flat surface area allows set screws to dig into shaft for securely mounting gears, sprockets and bearings.

Threaded Rotary Shafts

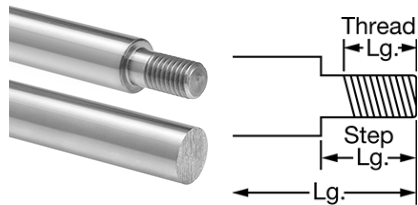

Attach threaded accessories such as mixer propellers and fan blades to the end of these shafts.

Tapped Rotary Shafts

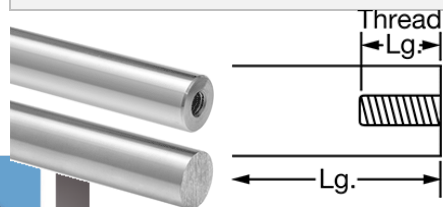

Connect these internally threaded shafts directly to threaded components, or use a fastener to secure them.

Company Profile

Business Interests

Thread-Mount Idler Rotary Shafts

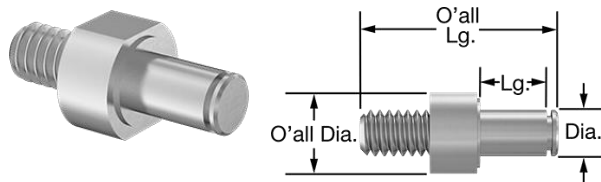

Threaded these shafts into a tapped hole to support idler sprockets and pulleys in tensioning applications. They have a retaining-ring groove, retaining ring, and spacers to position your component and hold it in place.

Flange-Mount Idler Rotary Shafts

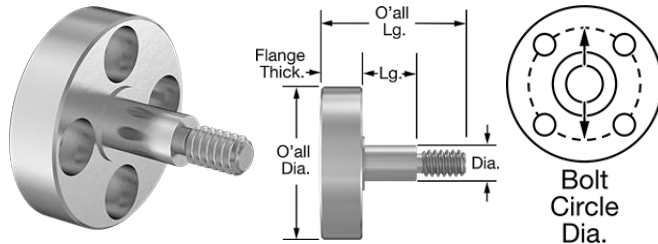

Mount the flange to a machine or wall to support idler sprockets and pulleys in tensioning applications. They include washers and a nut to position your component and hold it in place.

Company Profile

Business Interests

Rotary Shafts with Retaining Ring Grooves

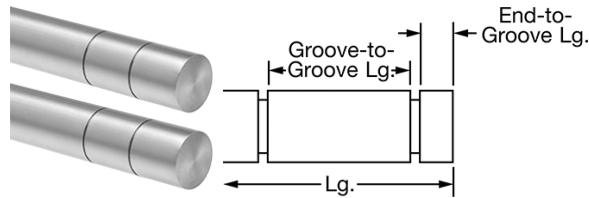

Clip retaining rings into the grooves to separate and position gear, sprockets, and bearings.

Step Down Rotary Shafts

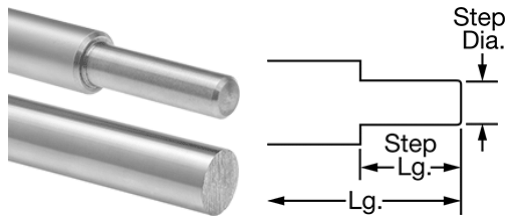

A shoulder near the end of the shaft provides a stop for gears, sprockets, and bearings.

Customized rotary shafts can be manufactured from (Ø4mm to Ø35mm) & lengths of 50mm to 500mm, ground & plated as per customer requirements.

Quality Management System - Certifications



CERTIFICATE

Management system as per
IATF 16949:2016
(1st edition, 2016-10-01)

Evidence of conformity with the above standard has been furnished and is certified for

Nitesh Auto Engineering Pvt. Ltd. Plant 1
M-26, MIDC Area, Ambad,
Nashik - 422 010,
India

Scope

Manufacture of Precision Machined Components

without product design responsibility (according to section 8.3)

with the Extended Manufacturing Site(s)

Nitesh Auto Engineering Pvt. Ltd. Plant 2 - M-18, MIDC, Ambad, Nashik - 422 010, India
Nitesh Auto Engineering Pvt. Ltd. Plant 3 - W-69(A), MIDC, Ambad, Nashik - 422 010, India

IATF Registration No. 0385371 Issue date: 2021-02-13
Certificate Registration No. 44 111 101903 Expiry date: 2024-02-12

W. Br. on dt
Certification body
at TÜV NORD CERT GmbH Essen, 2021-02-13

This certification was conducted in accordance with the IATF 'Rules for achieving and maintaining IATF recognition'.

TÜV NORD CERT GmbH Langemarkstraße 20 45141 Essen www.tuev-nord-cert.de



02-IAO-QMC-01021 page 1/1 A13F201a rev. 01/03.19



CERTIFICATE

Management system as per
ISO 9001 : 2015

In accordance with TÜV INDIA procedures, it is hereby certified that

NITESH AUTO ENGINEERING PVT. LTD. PLANT 1
M-26, MIDC Area, Ambad,
Nashik – 422 010,
India
and other locations as per Annexure

applies a management system in line with the above standard for the following scope

Manufacture of Precision Machined Components

Certificate Registration No. **QM 01 00542/01** Valid until **12.02.2024**
Audit Report No. **Q 5404/2014** Initial Certification **13.02.2014**

W. Br. on dt
Certification Body
at TÜV INDIA PVT. LTD. Issue **13.02.2021**
Place : **Mumbai**

This certification was conducted in accordance with the TÜV INDIA auditing and certification procedures & shall be valid subject to regular Surveillance Audits.

TUV India Pvt. Ltd., 801, Raheja Plaza – 1, L.B.S. Marg, Ghatkopar (W), Mumbai - 400 086, India cert.helpdesk@tuvindia.co.in



Branch Office:
TUV INDIA PRIVATE LIMITED
TUV INDIA HOUSE
Survey No.42, 311 & 3/2, Village:
SUS, Tal: MULSHI, PUNE- 411 021
Tel.No: 020-6790000
E-mail : qa@tuv-nord.com
Website : www.tuv-nord.com/in

SAP-NO: 8114916886
TUV-File: 8114916886

Agreement
concerning the correct restamping
of materials and products

according Guideline AD 2000 and
Pressure Equipment Directive

Between the Company

Ms. Nitesh Auto Engineering Pvt Ltd
M-26, MIDC Ambad,
Nashik- 422010,
Maharashtra, India

Herein after called as owner of the agreement

and

TUV INDIA PRIVATE LIMITED
TUV INDIA HOUSE
Survey No.42, 311 & 3/2,
Village: SUS, Tal: MULSHI,
PUNE- 411 021

agree as follows:

The owner of the agreement may, subject to the restrictions stipulated in the following sections, restamp materials/products in accordance with Guideline AD 2000 (Pressure Equipment Directive)

The owner of the agreement appoints the following works employees to be responsible for this process:

Name	ID Stamp	Signature
Mr. Vijay Prasad	NU-02	<i>[Signature]</i>
Mr. Rakesh Dayal	NU-03	<i>[Signature]</i>
Ms. Pratiksha Ghule	NU-04	<i>[Signature]</i>
Mr. Arshad Shaikh	NU-05	<i>[Signature]</i>
Mr. Unni Kannan	NU-06	<i>[Signature]</i>

Those persons to carry out restamping were informed of their obligations in this respect by TÜV on **05.01.2021**.

Head Office: TÜV India Private Limited, 801, Raheja Plaza-1, L.B.S. Marg, Ghatkopar (W), Mumbai-400086 Tel.No.: 022-66477009
Fax No.:022 66477009. CIN NO-U74140MH1989PTC052930



Infrastructure

Manufacturing Setup

Plant 1: M-26, MIDC, Ambad, Nashik. Maharashtra.

- Head Office & manufacturing location.
- Total area:
- Available space: 0%
- Spare production capacity: 5%

Plant 2: M-18, MIDC, Ambad, Nashik. Maharashtra.

- Manufacturing location.
- Total area: 12000 Sq. Ft
- Available space: 60% (8000 Sq. Ft)
- Spare production capacity: 30%

Plant 3: W-69(A), MIDC, Ambad, Nashik. Maharashtra.

- Manufacturing location.
- Total area: 12000 Sq. Ft
- Available space: 40% (4000 Sq. Ft)
- Spare production capacity: 30%

Plant 4: M-26, Sector 3, Pithampur. Madhya Pradesh,

- Manufacturing location.
- Total area: 3000 Sq. Ft
- Available space: 100% (3000 Sq. Ft)
- Spare production capacity: 100%

24/7 Power
available through
backup in all
plants.

New plant
coming in
Nashik by
2024

Infrastructure

Manufacturing Capacity

Machining Process

- Automats – Traub.
- Automatic Lathes – CNC's.
- Four Axis Machining Centre – VMC.
- Turn-mill machine.
- Thread Rolling machines.
- Milling machines.
- Drilling center.
- Deep hole drilling.
- Hex punching.

We turn & grind from $\text{Ø}3\text{mm}$ to $\text{Ø}205\text{mm}$. Length from 3mm to 550 mm.

Grinding Process

- Centerless Grinder, Width 20".
- Rotary Surface Grinder.
- Tool & Cutter Grinder.

Heat Treatment

- High speed Induction Heat treatment for shafts from $\text{Ø}8\text{mm}$ to $\text{Ø}30\text{mm}$.

Cleaning machine

- 4 stage Ultrasonic cleaning machine for parts.
- Vibro de-burring machine.

We use various ferrous & non-ferrous raw material as per customer requirement.

Presently working with the following RM's,

- High Speed Steel.
- Case Hardened Steel.
- Bearing Steel.
- Stainless Steel.
- Brass & Copper.
- Aluminium.

Infrastructure

Manufacturing Capacity – Latest Machines Delivered & Ordered

Turn Mill Centre – **Delivered and installed**



Sliding Head CNC – Planned by end 2022



Infrastructure

Manufacturing Capacity – Latest Machines Delivered & Ordered

Centerless Grinder – Set of Three machines order.

20 Inch – 2 Nos

10 Inch – 2 Nos

Delivered and installed



Infrastructure

Manufacturing Capacity – Available Machines

VMC – 4 Axis



Turning Centre



Infrastructure

Manufacturing Capacity – Available Machines

Centerless Grinder



Automats



Infrastructure

Manufacturing Capacity – Available Machines

High Frequency Induction Heat treatment

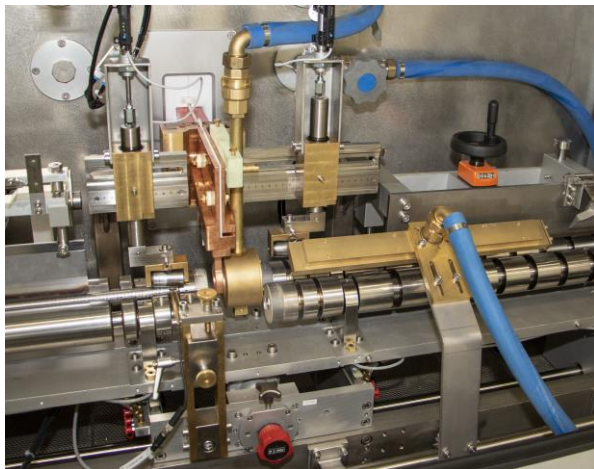

Thread Rolling



NAEP

Infrastructure

Inspection Facility

Geometric measurement

- Digital Vernier Calipers.
- Digital Micrometers.
- 2D Height Gauge.
- Holematic bore gauge.
- Micro/ Bore Gauges.
- Profile Projector.
- Air Plug/ Ring Gauge.
- Plating thickness inspection.
- Digital plunger dials.
- Dial snap gauges.

Profile inspection

- Profile Projector.
- Contour tracer.
- Roundness & Cylindricity measuring equipment.
- Surface roughness tester.

Destructive inspection

- UTM – Universal Testing machine.
- Vickers Micro hardness tester.
- Rockwell hardness tester.

We make sure we have similar instruments as our customer has to avoid ambiguity of inspection.

Attribute inspection

- Crack detection.
- Thread Ring gauges.
- Slip gauges.
- Plug gauges.
- Snap gauges.

We upgrade our inspection instruments as per process criticality & need of the hour.

Presently upgradation is on the following,

- Visual Inspection setup.
- CMM – Co-ordinate Measuring Machine.

Infrastructure

Inspection Facility – Future addition

CMM – Co-ordinate measuring machine



Vision measurement



Infrastructure

Inspection Facility – Available Instruments

Contour tracer



Profile Projector/ Shadow graph



Micro vickers hardness



Cylindricity & Roundness tester



Surface roughness tester



Digital bore gauge from 1.5mm to 65mm

Employee development & recognitions

Performance awards



In-house training activities



CSR Activities

Medical checkup



Blood donation camp

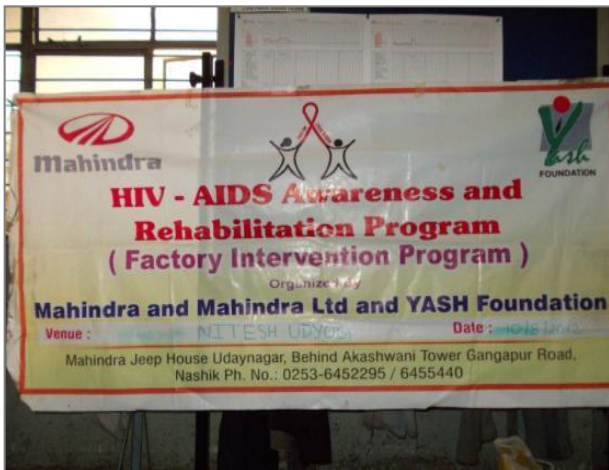

CSR Activities

Birthday Celebration



Infrastructure

Product Range



Infrastructure

Product Range



Infrastructure

Product Range



Infrastructure

Product Range



Infrastructure

Product Range



Infrastructure

Product Range



Thank You !

